

---

# MANUFACTURING WORLD CLASS FUNCTIONAL AUTO PARTS

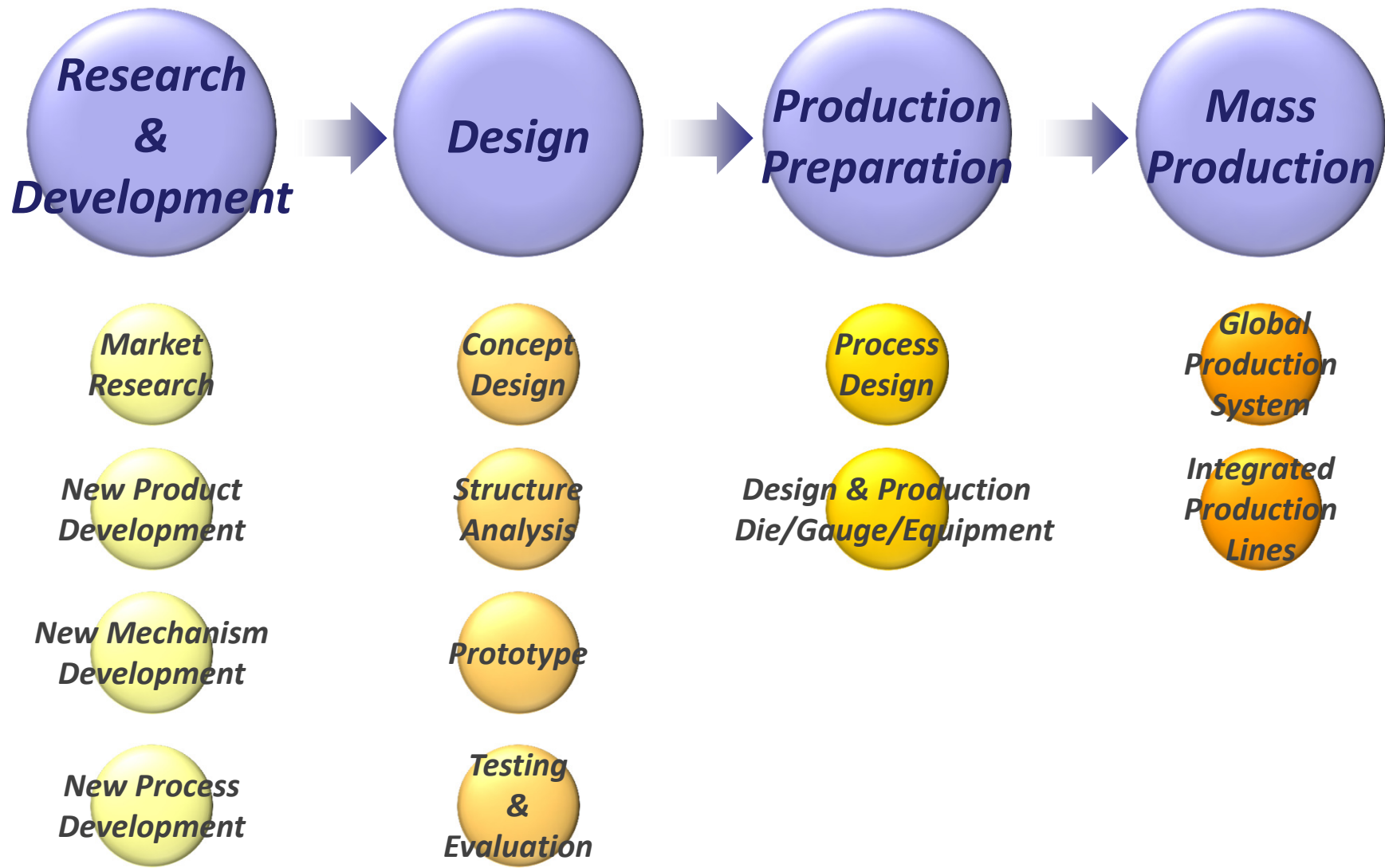

**OTSCON MEXICO**



# Global Locations

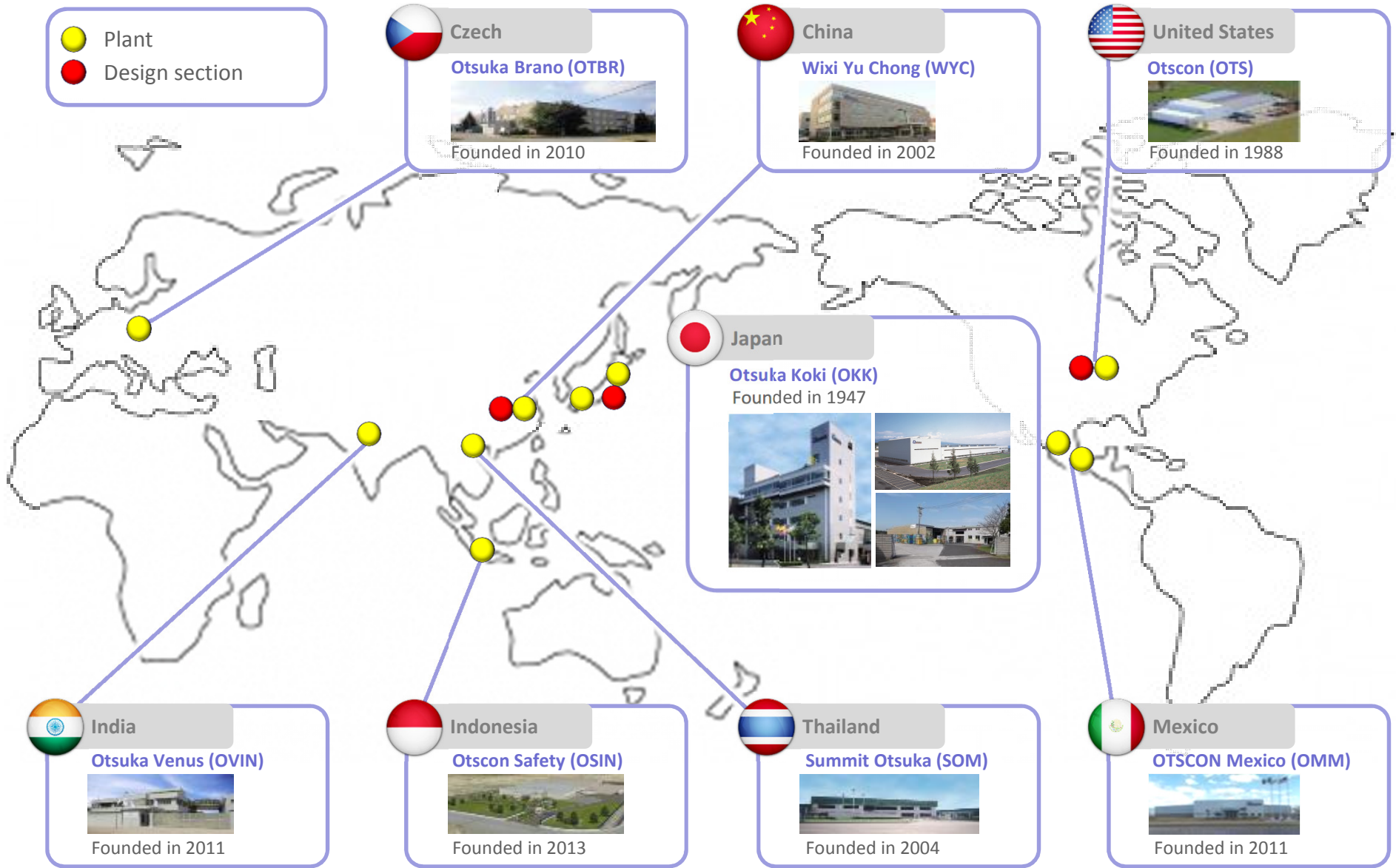

# Global Network



Location	Group Company								TECHNICAL ALLIANCE
	JAPAN	USA	MEXICO	CHINA	THAILAND	CZECH	INDIA	INDONESIA	TAIWAN
	OKK	OTS	OMM	WYC	SOM	OTBR	OVIN	OSIN	HSIN CHONG
Honda	●	●	●	●	●	●	●	●	●
Nissan	●	●	●	●	●	●	●	●	●
Suzuki	●			●		●	●	●	
Toyota	●	●	●	●	●		●		●
Daihatsu	●				●			●	
Subaru	●	●	●						
Hino	●								
Isuzu	●				●		●		
Mitsubishi	●								
Mazda			●						
Audi			●						
GM				●	●				
Local				●			●		
Tier 1			●						

# ■ In-House Production



Proficient JIT scheduling of production processes to minimize inventory and lead times.



CARBURIZED HEAT TREATMENT

ASSEMBLE



STAMPING PRG/TDM



WELDING Robotic Spot / Projection / Mig / Tig



MOLDING Resin



# Complete Quality



In-house testing for all processes.



FFT ANALYZER IN ANECHOIC ROOM



DURABILITY TESTING



TEMPERATURE AND HUMIDITY CHAMBER



VIBRATION TEST MACHINE



Cutting parts on band saw



Parts after being cut on



Parts sanded before acid test



Parts sanded on belt



Front View



Left Side View



Light switch screw torque



Acid Bath



Depth of penetration



Preparing loupe to read penetration

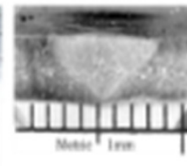

Reading penetration



Right Side View



Pin staking

PART VERIFICATION

## Global Locations -Otsuka koki Co., Ltd.-



### Otsuka Koki Co., Ltd. (Parent Company)

- ◇ **Established:** 1947
- ◇ **Capital:** 308 million JPY
- ◇ **Head Office:** Yokohama, Japan
- ◇ **Production Locations:** Japan 2 plants  
Overseas 8 plants
- ◇ **Employees:** 1,050 (Japan 350, Overseas 700)
- ◇ **Certificate:** IATF16949

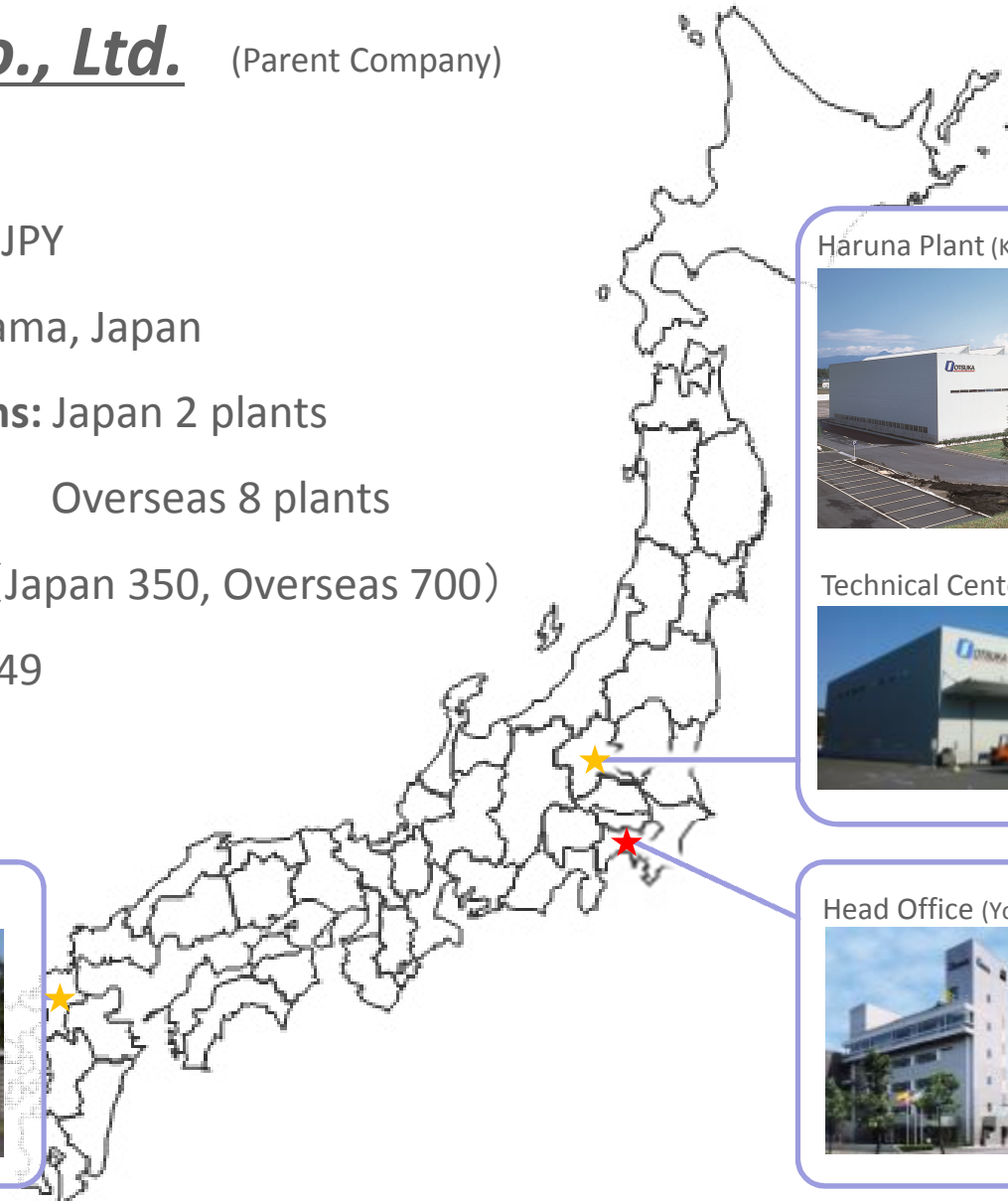

## Global Locations -Otsccon, inc USA-



### Otscon, inc USA

(Columbia Missouri USA)

- ◇ **Established:** 1988
- ◇ **Employees:** 265
- ◇ **Plant Size:** 10,200 m2
- ◇ **Equipment:**
  - PRG Stamping
  - TDM Stamping
  - Injection Molding
  - Robot Welding
  - Assembly
- ◇ **Certificate:** IATF16949



Otscon, inc





## Global Locations -Otscon, inc USA-



TYPE	QTY
AIDA 600 Ton Link Motion Press (PRG)	2
AIDA 110 Ton Link Motion Press	2
280 Ton Kawaguchi Molding Machine	1
Robot Spot Welder	1
Electric Resistance Welding (SPOT&PRJ)	9
ARC Welding Robot	7

### Equipment



## ***OTSCON Mexico Manufacturing, S.A de C.V***

(San Luis Potosi, Puebla de Zaragoza)

- ◇ **Established:** 2011
- ◇ **Employees:** 140
- ◇ **Plant Size:** 9,360 m<sup>2</sup>
- ◇ **Land Size:** 45,000 m<sup>2</sup>
- ◇ **Equipment:**
  - PRG Stamping
  - TDM Stamping
  - Injection Molding
  - Robot Welding
  - Assembly
- ◇ **Certificate:** IATF16949



Puebla Plant

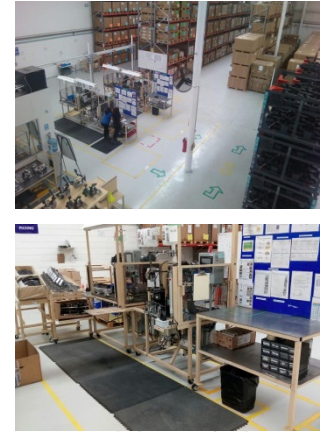

San Luis Potosi Plant



**TYPE**

**Equipment**

**<Stamping Machine>**

- AIDA 300 Ton Servo Press (PRG) x 2
- AIDA 110 Ton Servo Press (PRG) x 1
- AIDA 110 Ton Press (TDM) x 2
- AIDA 80 Ton Press (TDM) x 1

**<Molding Machine>**

- 280 Ton Kawaguchi Molding Machine x 1
- 280 Ton JSW Molding Machine x 1
- 55 Ton JSW Molding Machine x 1

**<Welding Machine>**

- Robot Spot Welder x 1
- Projection Robot x 4
- ARC Welding Robot x 3 (Extra 2 since 2021)

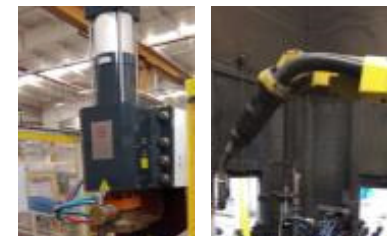

# Global Locations -Otsccon Mexico Manufacturing, S.A de C.V-



## Stamping Machine

		300t Servo	300t Servo	110t Servo	110t TDM	80t TDM
		DSF-N2-3000	DSF-N2-3000	DSF-C1-1100	NC1-1100(2)E	NC1-800(2)E
Capacity	(kN)	3000	3000	1100	1100	800
	(US ton)	-	330	121	121	88
Blanking Capacity	(kN)	-	-	880	880	640
	(US ton)	-	-	97	97	70
Slide Stroke	(mm)	300	300	180	180	160
Strokes per Minute: No Load	(min)	-35	-35	-70	35 - 65	45 - 75
Die Height	(mm)	600	600	350	350	320
Slide Adjustment	(mm)	130	130	90	90	80
Slide Area: L · R x F · B	(mm)	2400 x 900	2400 x 900	630 x 520	630 x 520	540 x 460
Bolster area: L · R x F · B	(mm)	2400 x 1200	2400 x 1200	1140 x 680	1070 x 680	950 x 600
Main Moter	(kW)	-	50	-	7.5	7.5
Required Air pressure	(MPa)	0.5	0.5	0.5	0.5	0.5
Max. Upper Die Weight	(kg)	2300	2300	218	256	203
Qty		1	1	1	2	1

## Leveler feeder

		↓	↓	↓		
Power supply	(V)	220	220	220		
	(Hz)	60	60	60		
	(KVA)	30.1	27.2	10.8		
Machine Mass	(Kg)	2560	2080	765		
Width	(mm)	50 - 500	70 - 500	50 - 300		
Thickness	(mm)	0.6 - 6.0	0.6 - 6.0	0.3 - 3.2		
Line speed Max.	(m/min)	22	22	16		
Coil Mass Max	(Kg)	3000	3000	2000		
Top Speed	(m/sec)	1.319	1.319	1.555		



# ■ Products 1

Lever type Parking Brake



Foot type Parking Brake



## ■ Products 2

Foot type Parking Brake



Forklift Parking Brake



Motorcycle Parking Brake



Brake Pedal



## ■ Products 3

Pedal Box

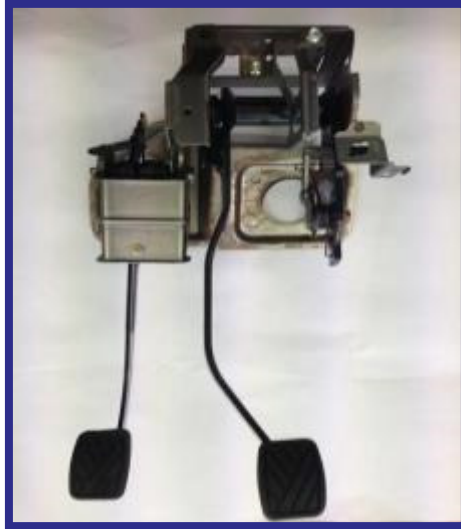

Clutch Pedal

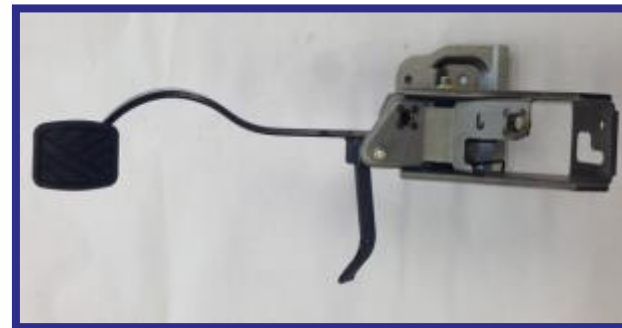

# ■ Products 4

## Stamping Parts

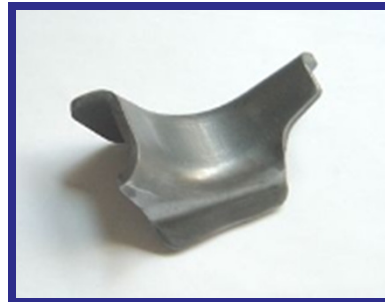



## Contact Information



### ◇ Location :

#### SLP Plant

AV. Central #445, Eje 140 No.365  
Col. Parque Logistico  
San Luis Potosi, S.L.P., Mexico  
C.p. 78395 (WTC)

#### PBC Plant

Cerrada de Laurel Nave 3C  
Parque Industrial Finsa  
Km 117, Cuautlancingo, Puebla  
C.p. 72710

### ◇ Contact Person :

**Adrian Paz Tovar**

**Sales Manager**

**Mail: [a.paz@otscon.com](mailto:a.paz@otscon.com)**

**Phone: +52 (444) 161 5065**

**Mobile: 44 48 40 07 38**

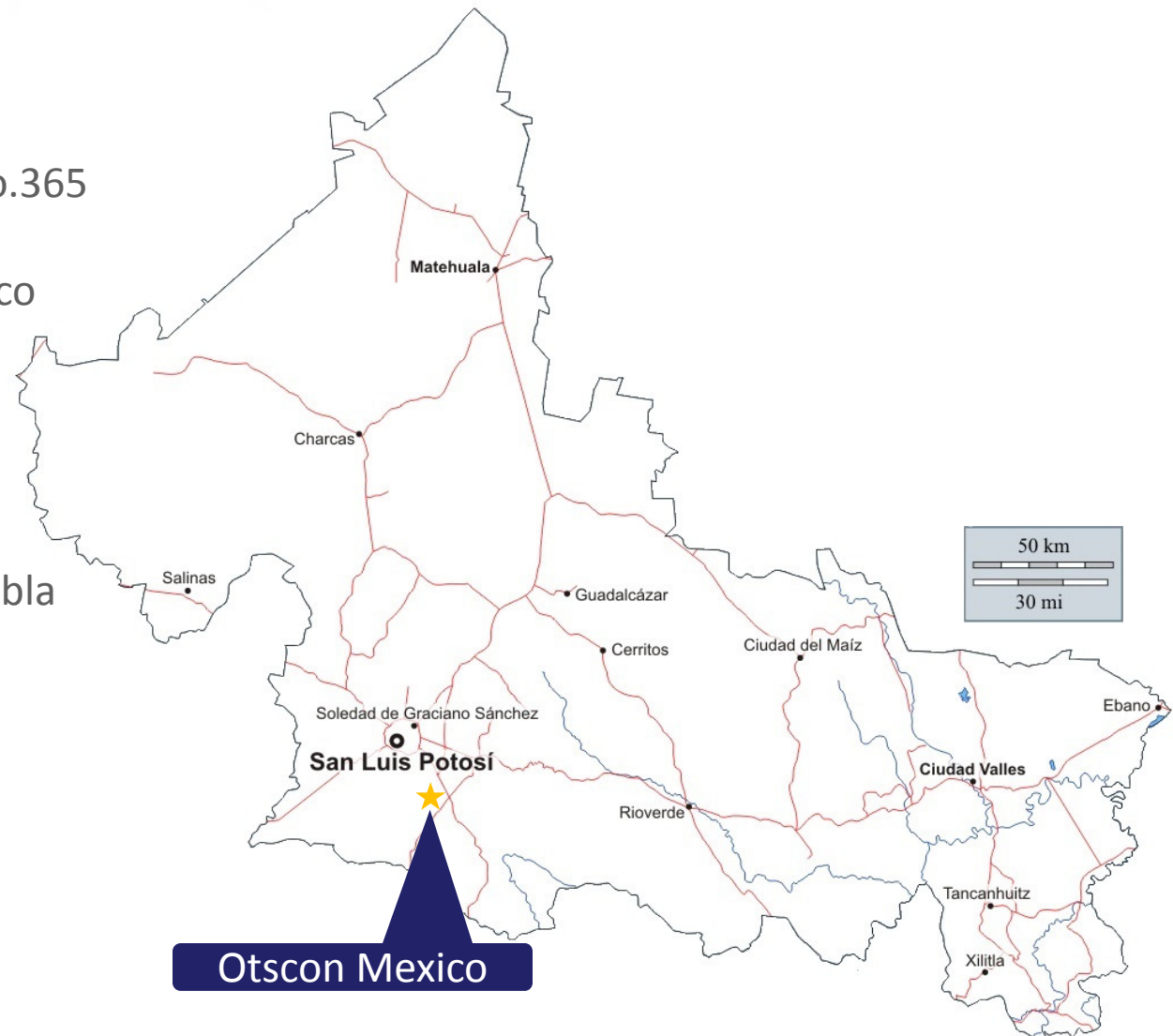

---



**THANK YOU**